

PROPERTY OWNER/DEVELOPER  
 PROCEEDS FROM THE SALE OF THIS PROJECT WILL BE DONATED TO THE TEXAS WILSON ENGINEERING COMPANY  
 P.O. BOX 79074  
 SETTLER'S CROSSING, INC.  
 579-865-6262

**BUILDING LINES**  
 FRONT = 50' B.L.  
 SIDE STREET = 50' B.L.  
 REAR = 15' B.L.

LINE	TABLE	COORDINATES	ACRES
1	1	N 42°35'04" E 225.00'	1.350
2	2	N 42°35'04" E 241.53'	1.108
3	3	N 42°35'04" E 282.06'	1.178
4	4	N 42°35'04" E 282.06'	1.108
5	5	N 42°35'04" E 241.53'	1.071
6	6	N 42°35'04" E 225.00'	1.072
7	7	N 42°35'04" E 225.00'	1.057
8	8	N 42°35'04" E 225.00'	1.081
9	9	N 42°35'04" E 225.00'	1.272
10	10	N 42°35'04" E 225.00'	1.143
11	11	N 42°35'04" E 225.00'	1.070
12	12	N 42°35'04" E 225.00'	1.198
13	13	N 42°35'04" E 225.00'	1.183
14	14	N 42°35'04" E 225.00'	1.221
15	15	N 42°35'04" E 225.00'	1.105
16	16	N 42°35'04" E 225.00'	1.046
17	17	N 42°35'04" E 225.00'	1.059
18	18	N 42°35'04" E 225.00'	1.064
19	19	N 42°35'04" E 225.00'	1.060
20	20	N 42°35'04" E 225.00'	1.055
21	21	N 42°35'04" E 225.00'	1.041
22	22	N 42°35'04" E 225.00'	1.109
23	23	N 42°35'04" E 225.00'	1.133
24	24	N 42°35'04" E 225.00'	1.077
25	25	N 42°35'04" E 225.00'	1.106
26	26	N 42°35'04" E 225.00'	1.497
27	27	N 42°35'04" E 225.00'	1.270
28	28	N 42°35'04" E 225.00'	1.110
29	29	N 42°35'04" E 225.00'	1.044
30	30	N 42°35'04" E 225.00'	1.062
31	31	N 42°35'04" E 225.00'	1.064
32	32	N 42°35'04" E 225.00'	1.060
33	33	N 42°35'04" E 225.00'	1.048
34	34	N 42°35'04" E 225.00'	1.052
35	35	N 42°35'04" E 225.00'	1.091
36	36	N 42°35'04" E 225.00'	1.098
37	37	N 42°35'04" E 225.00'	1.074
38	38	N 42°35'04" E 225.00'	1.242
39	39	N 42°35'04" E 225.00'	1.130
40	40	N 42°35'04" E 225.00'	1.050
41	41	N 42°35'04" E 225.00'	1.052
42	42	N 42°35'04" E 225.00'	1.061
43	43	N 42°35'04" E 225.00'	1.043
44	44	N 42°35'04" E 225.00'	1.070
45	45	N 42°35'04" E 225.00'	1.042
46	46	N 42°35'04" E 225.00'	1.290

CURVE	RADIUS	ARC LENGTH	CHORD BEARING
C1	350.00'	134.54'	N 105°14'09" E
C2	350.00'	134.54'	N 105°14'09" W
C3	350.00'	134.54'	S 105°14'09" W
C4	350.00'	134.54'	S 105°14'09" E
C5	350.00'	134.54'	N 105°14'09" E
C6	350.00'	134.54'	N 105°14'09" W
C7	350.00'	134.54'	S 105°14'09" W
C8	350.00'	134.54'	S 105°14'09" E
C9	350.00'	134.54'	N 105°14'09" E
C10	350.00'	134.54'	N 105°14'09" W
C11	350.00'	134.54'	S 105°14'09" W
C12	350.00'	134.54'	S 105°14'09" E
C13	350.00'	134.54'	N 105°14'09" E
C14	350.00'	134.54'	N 105°14'09" W
C15	350.00'	134.54'	S 105°14'09" W
C16	350.00'	134.54'	S 105°14'09" E
C17	350.00'	134.54'	N 105°14'09" E
C18	350.00'	134.54'	N 105°14'09" W
C19	350.00'	134.54'	S 105°14'09" W
C20	350.00'	134.54'	S 105°14'09" E
C21	350.00'	134.54'	N 105°14'09" E
C22	350.00'	134.54'	N 105°14'09" W
C23	350.00'	134.54'	S 105°14'09" W
C24	350.00'	134.54'	S 105°14'09" E
C25	350.00'	134.54'	N 105°14'09" E
C26	350.00'	134.54'	N 105°14'09" W
C27	350.00'	134.54'	S 105°14'09" W
C28	350.00'	134.54'	S 105°14'09" E
C29	350.00'	134.54'	N 105°14'09" E
C30	350.00'	134.54'	N 105°14'09" W
C31	350.00'	134.54'	S 105°14'09" W
C32	350.00'	134.54'	S 105°14'09" E
C33	350.00'	134.54'	N 105°14'09" E
C34	350.00'	134.54'	N 105°14'09" W
C35	350.00'	134.54'	S 105°14'09" W
C36	350.00'	134.54'	S 105°14'09" E
C37	350.00'	134.54'	N 105°14'09" E
C38	350.00'	134.54'	N 105°14'09" W
C39	350.00'	134.54'	S 105°14'09" W
C40	350.00'	134.54'	S 105°14'09" E
C41	350.00'	134.54'	N 105°14'09" E
C42	350.00'	134.54'	N 105°14'09" W
C43	350.00'	134.54'	S 105°14'09" W
C44	350.00'	134.54'	S 105°14'09" E
C45	350.00'	134.54'	N 105°14'09" E
C46	350.00'	134.54'	N 105°14'09" W
C47	350.00'	134.54'	S 105°14'09" W
C48	350.00'	134.54'	S 105°14'09" E
C49	350.00'	134.54'	N 105°14'09" E
C50	350.00'	134.54'	N 105°14'09" W
C51	350.00'	134.54'	S 105°14'09" W
C52	350.00'	134.54'	S 105°14'09" E
C53	350.00'	134.54'	N 105°14'09" E
C54	350.00'	134.54'	N 105°14'09" W
C55	350.00'	134.54'	S 105°14'09" W
C56	350.00'	134.54'	S 105°14'09" E
C57	350.00'	134.54'	N 105°14'09" E
C58	350.00'	134.54'	N 105°14'09" W
C59	350.00'	134.54'	S 105°14'09" W
C60	350.00'	134.54'	S 105°14'09" E
C61	350.00'	134.54'	N 105°14'09" E
C62	350.00'	134.54'	N 105°14'09" W
C63	350.00'	134.54'	S 105°14'09" W
C64	350.00'	134.54'	S 105°14'09" E
C65	350.00'	134.54'	N 105°14'09" E
C66	350.00'	134.54'	N 105°14'09" W
C67	350.00'	134.54'	S 105°14'09" W
C68	350.00'	134.54'	S 105°14'09" E
C69	350.00'	134.54'	N 105°14'09" E
C70	350.00'	134.54'	N 105°14'09" W
C71	350.00'	134.54'	S 105°14'09" W
C72	350.00'	134.54'	S 105°14'09" E
C73	350.00'	134.54'	N 105°14'09" E
C74	350.00'	134.54'	N 105°14'09" W
C75	350.00'	134.54'	S 105°14'09" W
C76	350.00'	134.54'	S 105°14'09" E
C77	350.00'	134.54'	N 105°14'09" E
C78	350.00'	134.54'	N 105°14'09" W
C79	350.00'	134.54'	S 105°14'09" W
C80	350.00'	134.54'	S 105°14'09" E
C81	350.00'	134.54'	N 105°14'09" E
C82	350.00'	134.54'	N 105°14'09" W
C83	350.00'	134.54'	S 105°14'09" W
C84	350.00'	134.54'	S 105°14'09" E
C85	350.00'	134.54'	N 105°14'09" E
C86	350.00'	134.54'	N 105°14'09" W
C87	350.00'	134.54'	S 105°14'09" W
C88	350.00'	134.54'	S 105°14'09" E
C89	350.00'	134.54'	N 105°14'09" E
C90	350.00'	134.54'	N 105°14'09" W
C91	350.00'	134.54'	S 105°14'09" W
C92	350.00'	134.54'	S 105°14'09" E
C93	350.00'	134.54'	N 105°14'09" E
C94	350.00'	134.54'	N 105°14'09" W
C95	350.00'	134.54'	S 105°14'09" W
C96	350.00'	134.54'	S 105°14'09" E
C97	350.00'	134.54'	N 105°14'09" E
C98	350.00'	134.54'	N 105°14'09" W
C99	350.00'	134.54'	S 105°14'09" W
C100	350.00'	134.54'	S 105°14'09" E

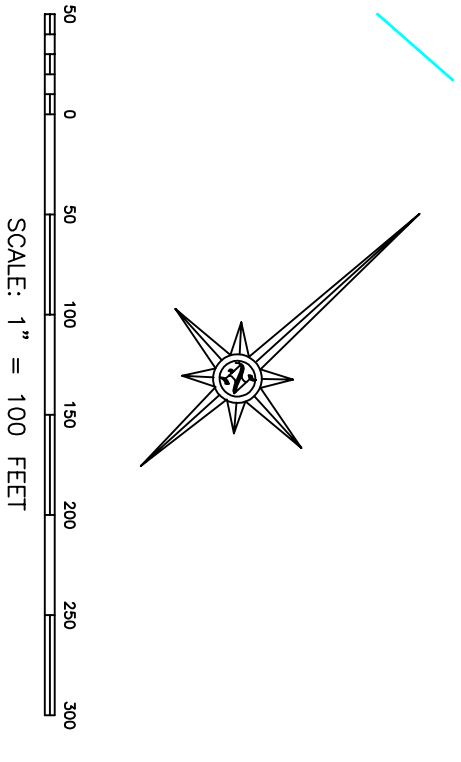
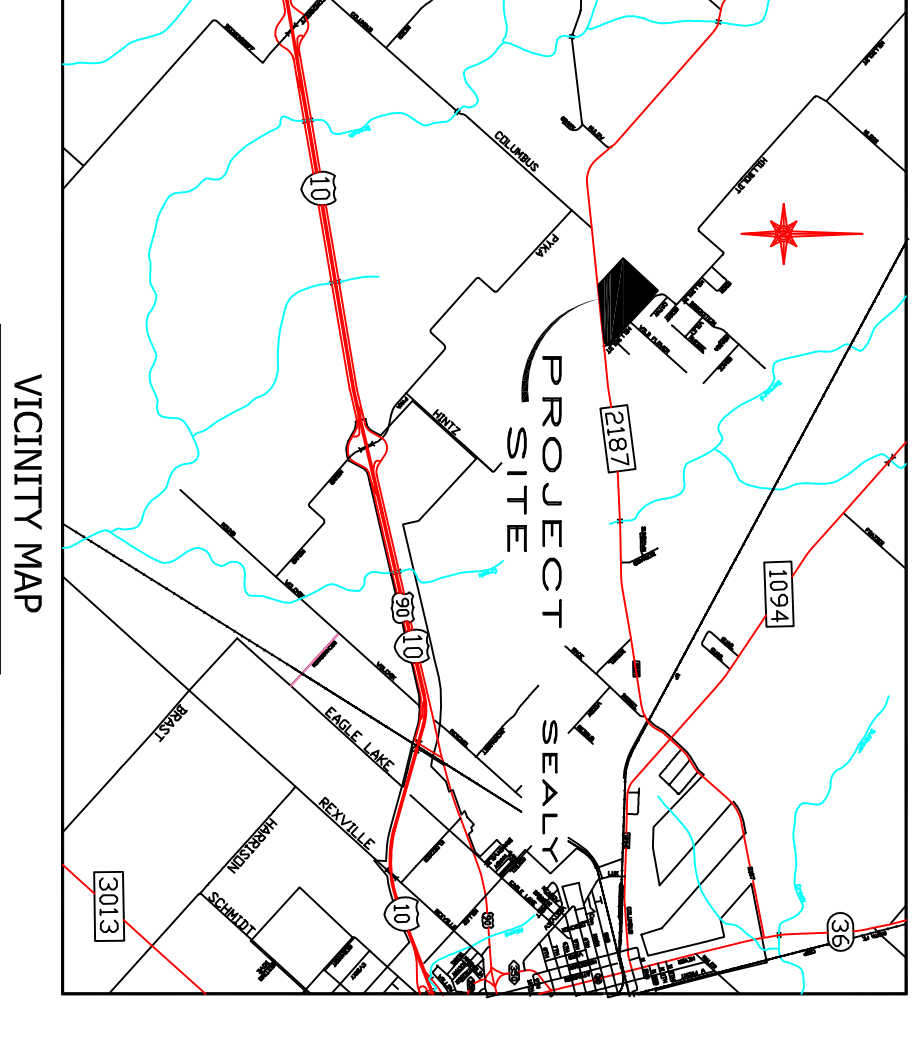

**ABBREVIATION LEGEND:**  
 IR = IRON ROD  
 RP = IRON PIPE  
 FND = FOUND  
 P = POINT  
 O.P.R. = OFFICIAL PUBLIC RECORDS  
 A.C.C.F. = AUSTIN COUNTY CLERK'S FILE  
 O.P.R. = OFFICIAL PUBLIC RECORDS  
 A.C.C.F. = AUSTIN COUNTY CLERK'S FILE  
 V.L. = VOLUME  
 P.P. = POWER POLE  
 O.H. ELEC. = OVERHEAD ELECTRICAL LINE  
 S.F. = SQUARE FEET PER SQUARE FOOT  
 ROW = RIGHT OF WAY

20190607  
 Surveyor KDM  
 Scale 1"=100'

**MARKETING EXHIBIT**  
**SETTLER'S RIDGE**  
 87.157 ACRES - 56 LOTS - 2 BLOCKS - 2 RESERVES  
 FRANZ KOY SURVEY, A-348,  
 (H.&T.C.R. SECTION 176),  
 AUSTIN COUNTY

**KM Surveying, LLC**  
 3902C REESE ROAD - SUITE 100  
 ROSENBERG, TEXAS 77471  
 www.kmsurveying.com

**WILSON ENGINEERING COMPANY, PLLC.**  
 208 FOWLKES STREET  
 SEALY, TEXAS 77474  
 PHONE: 979-885-3344  
 FAX: 979-885-3379  
 www.wilsoneng.com

**TXBPE Firm No. F-7678**

Drawn By: DWK  
 Date: 6-7-2019  
 Job Number: 18043  
 Sheet: 1 of 1