

PROPERTY OWNER/DEVELOPER  
 PROGRESSIVE SURVEYING, INC.  
 P.O. BOX 79074  
 DALLAS, TEXAS 75279  
 972-865-6262

LINE	TABLE
1	1089.25'
2	1089.25'
3	1089.25'
4	1089.25'
5	1089.25'
6	1089.25'
7	1089.25'
8	1089.25'
9	1089.25'
10	1089.25'
11	1089.25'
12	1089.25'
13	1089.25'
14	1089.25'
15	1089.25'
16	1089.25'
17	1089.25'
18	1089.25'
19	1089.25'
20	1089.25'
21	1089.25'
22	1089.25'
23	1089.25'
24	1089.25'
25	1089.25'
26	1089.25'
27	1089.25'
28	1089.25'
29	1089.25'
30	1089.25'
31	1089.25'
32	1089.25'
33	1089.25'
34	1089.25'
35	1089.25'
36	1089.25'
37	1089.25'
38	1089.25'
39	1089.25'
40	1089.25'
41	1089.25'
42	1089.25'
43	1089.25'
44	1089.25'
45	1089.25'
46	1089.25'
47	1089.25'
48	1089.25'
49	1089.25'
50	1089.25'
51	1089.25'
52	1089.25'
53	1089.25'
54	1089.25'
55	1089.25'
56	1089.25'
57	1089.25'
58	1089.25'
59	1089.25'
60	1089.25'
61	1089.25'
62	1089.25'
63	1089.25'
64	1089.25'
65	1089.25'
66	1089.25'
67	1089.25'
68	1089.25'
69	1089.25'
70	1089.25'
71	1089.25'
72	1089.25'
73	1089.25'
74	1089.25'
75	1089.25'
76	1089.25'
77	1089.25'
78	1089.25'
79	1089.25'
80	1089.25'
81	1089.25'
82	1089.25'
83	1089.25'
84	1089.25'
85	1089.25'
86	1089.25'
87	1089.25'
88	1089.25'
89	1089.25'
90	1089.25'
91	1089.25'
92	1089.25'
93	1089.25'
94	1089.25'
95	1089.25'
96	1089.25'
97	1089.25'
98	1089.25'
99	1089.25'
100	1089.25'

**BUILDING LINES**  
 FRONT = 50' B.L.  
 SIDE STREET = 50' B.L.  
 REAR = 15' B.L.

CURVE	RADIUS	ARC LENGTH	CHORD	BEARING
C1	350.00'	34.54'	133.71'	N165°14'09"
C2	350.00'	220.125'	113.38'	N57°01'18"
C3	353.00'	48.86'	47.17'	N57°01'18"
C4	353.00'	17.24'	17.18'	N48°54'11"
C5	70.00'	58.42'	56.74'	N42°30'28"
C6	70.00'	51.83'	50.41'	N21°58'38"
C7	70.00'	51.83'	50.41'	N63°57'27"
C8	70.00'	58.17'	56.45'	S71°11'39"
C9	70.00'	58.17'	56.45'	S14°54'56"
C10	465.00'	51.32'	51.66'	S85°56'14"
C11	465.00'	60.9412'	64.42'	N33°17'40"
C12	353.00'	64.52'	64.42'	N33°17'40"
C13	353.00'	165.17'	163.50'	N24°56'13"
C14	353.00'	281.457'	163.50'	N24°56'13"
C15	265.00'	55.78'	55.68'	N42°30'28"
C16	265.00'	71.84'	71.62'	N39°24'42"
C17	70.00'	23.01'	22.81'	N72°17'51"
C18	70.00'	51.90'	50.22'	N21°58'38"
C19	70.00'	51.90'	50.22'	N63°57'27"
C20	70.00'	58.17'	56.51'	S71°11'39"
C21	70.00'	58.17'	56.51'	S17°17'51"
C22	353.00'	71.20'	71.06'	S41°05'26"
C23	353.00'	70.14'	69.86'	S27°17'38"
C24	433.00'	42.84'	42.81'	N28°07'02"
C25	355.00'	242.86'	238.41'	N28°07'02"
C26	355.00'	59.94546'	60.25'	N27°12'51"
C27	70.00'	23.01'	22.81'	N72°17'51"
C28	70.00'	58.35'	56.67'	N23°32'13"
C29	70.00'	58.35'	56.67'	N21°58'38"
C30	70.00'	51.49'	50.34'	N63°57'27"
C31	70.00'	51.49'	50.34'	S71°11'39"
C32	70.00'	51.49'	50.34'	S17°17'51"
C33	433.00'	182.29'	180.86'	S35°10'28"
C34	433.00'	107.15'	106.86'	S16°06'44"
C35	433.00'	184.25'	182.82'	S82°18'23"
C36	433.00'	178.54'	177.39'	S58°24'28"
C37	250.00'	106.51'	105.21'	S34°26'16"
C38	250.00'	242.86'	238.41'	N28°07'02"
C39	150.00'	106.29'	104.55'	N26°14'57"
C40	355.00'	292.02'	284.29'	N69°33'46"
C41	355.00'	108.96'	108.55'	S78°57'57"
C42	265.00'	134.13'	131.97'	S66°26'20"
C43	265.00'	134.13'	131.97'	S51°17'18"
C44	433.00'	172.59'	171.52'	S19°51'49"
C45	433.00'	172.59'	171.52'	S19°51'49"

**ABBREVIATION LEGEND:**  
 IR = IRON ROD  
 RP = IRON PIPE  
 FND = FOUND  
 P = POWER  
 P.P. = POWER POLE  
 OH. ELEC. = OVERHEAD ELECTRICAL LINE  
 S.F. = SQUARE FEET  
 S.F. = SQUARE FEET PER ANCHOR  
 ROW = RIGHT OF WAY

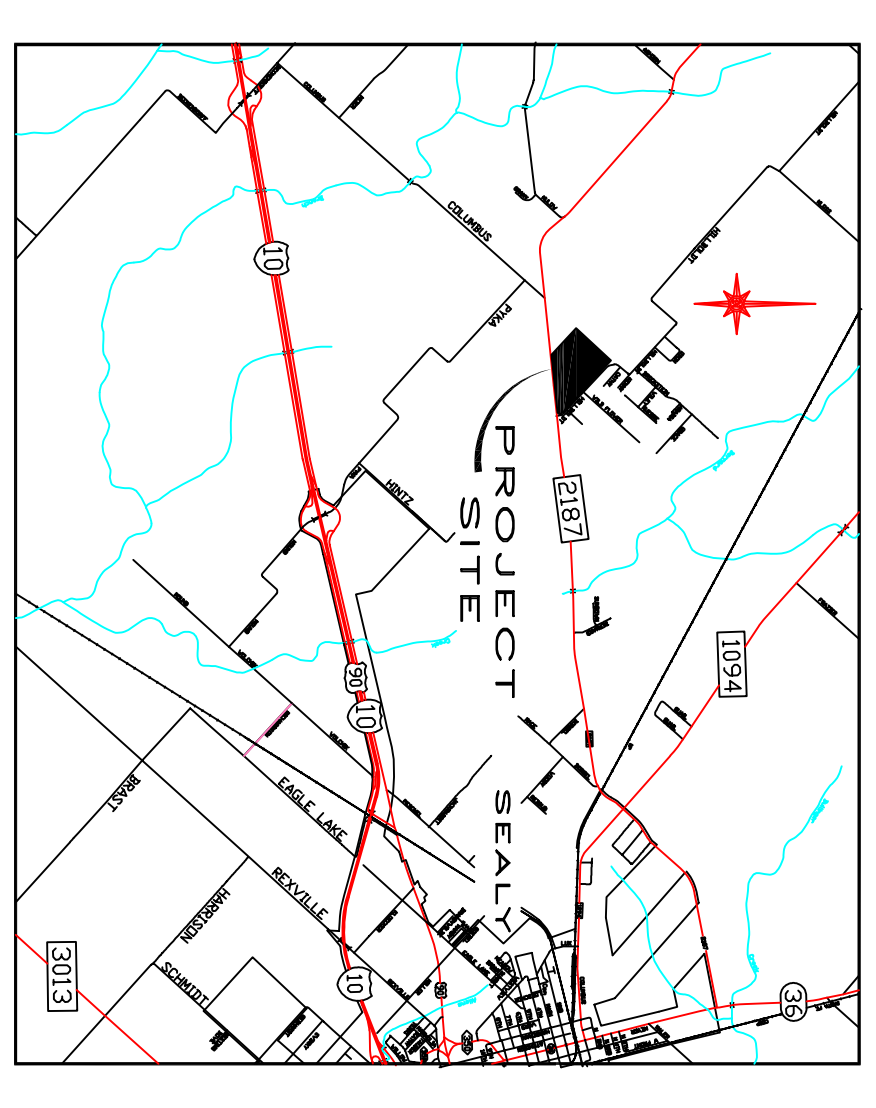

20190607

**MARKETING EXHIBIT**

**SETTLER'S RIDGE**

87.157 ACRES - 56 LOTS - 2 BLOCKS - 2 RESERVES

FRANZ KOY SURVEY, A-348,  
 (H.&T.C.R. SECTION 176),  
 AUSTIN COUNTY

**KM Surveying, LLC**  
 3902C REESE ROAD - SUITE 100  
 ROSENBERG, TEXAS 77471  
 www.kmsurveying.com  
 T8PE Firm No. F-7678

**WILSON ENGINEERING COMPANY, PLLC.**  
 208 FOWLKES STREET  
 SEALY, TEXAS 77474  
 PHONE: 979-885-3344  
 FAX: 979-885-3379  
 www.wilsoneng.com

Drawn By: DWR  
 Scale: 1"=100'  
 Date: 6-7-2019  
 Job Number: 18043  
 Sheet: 1 of 1